

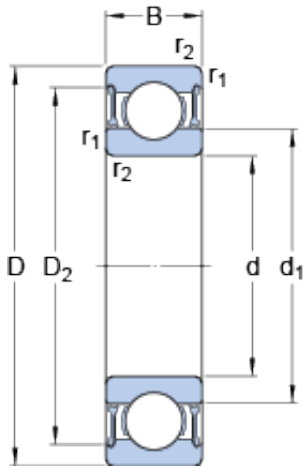

JieFei Bearing Co., Ltd



45 mm x 85 mm x 19 mm SKF
6209-2RZTN9/HC5C3WT deep groove ball
bearings

Bearing No. 6209-2RZTN9/HC5C3WT

6209-2RZTN9/HC5C3WT Bearing 2D drawings and 3D
CAD models

Size	85x45x19 mm
Bore Diameter	85 mm
Outer Diameter	45 mm
Width	19 mm
d	45 mm
D	85 mm
B	19 mm
d ₁	57.6 mm
D ₂	75.2 mm
d _a - min.	52 mm
d _a - max.	57.5 mm
D _a - max.	78 mm
r _a - max.	1 mm
Basic dynamic load rating - C	35.1 kN
Basic static load rating - C ₀	21.6 kN
Fatigue load limit - P _u	0.915 kN
Reference speed	22000 r/min
Limiting speed	13000 r/min
Calculation factor - k _r	0.025
Calculation factor - f ₀	14.2
Category	Single Row Ball Bearings
Inventory	0.0
Manufacturer Name	SKF



JieFei Bearing Co., Ltd

Minimum Buy Quantity	N/A
Weight / Kilogram	0.377
EAN	7316571642352
Product Group	B00308
Enclosure	2 Seals
Precision Class	ABEC 1 ISO P0
Maximum Capacity / Filling Slot	No
Rolling Element	Ball Bearing
Snap Ring	No
Internal Special Features	Silicon Nitride Rolling Element Electrical Insulated
Cage Material	Polyamide
Enclosure Type	Non-Contact Seal
Internal Clearance	C3-Loose
Inch - Metric	Metric
Long Description	45MM Bore; 85MM Outside Diameter; 19MM Outer Race Width; 2 Seals; Ball Bearing; ABEC 1 ISO P0; No Filling Slot; No Snap Ring; Silicon Nitride Rolling Element Electrical Insulated Internal Special
Other Features	Deep Groove NBR Seal Hybrid Silicon Nitride Rolling Element WT Standard Grease
Category	Single Row Ball Bearing
UNSPSC	31171504
Harmonized Tariff Code	8482.10.50.68
Noun	Bearing
Keyword String	Ball
Manufacturer URL	http://www.skf.com
Manufacturer Item Number	6209-2RZTN9/HC5C3WT



JieFei Bearing Co., Ltd

Weight / LBS	0.83
Outer Race Width	0.748 Inch 19 Millimeter
Inner Race Width	0 Inch 0 Millimeter
Bore	1.772 Inch 45 Millimeter
Outside Diameter	3.346 Inch 85 Millimeter
d_1	57.6 mm
D_2	75.2 mm
$r_{1,2}$ min.	1.1 mm
d_a min.	52 mm
d_a max.	57.5 mm
D_a max.	78 mm
r_a max.	1 mm
Basic dynamic load rating C	35.1 kN
Basic static load rating C_0	21.6 kN
Fatigue load limit P_u	0.915 kN
Calculation factor k_r	0.025
Calculation factor f_0	14.2
Mass bearing	0.42 kg